

Mobile monitors mounted on trailers, with or without foam tanks, can be used in several instances within oil refineries or hydrocarbons depots. SDM manufactures two types of trailers, both of them with the following specifications  
Full rubber wheels for max speed 25 kmh.

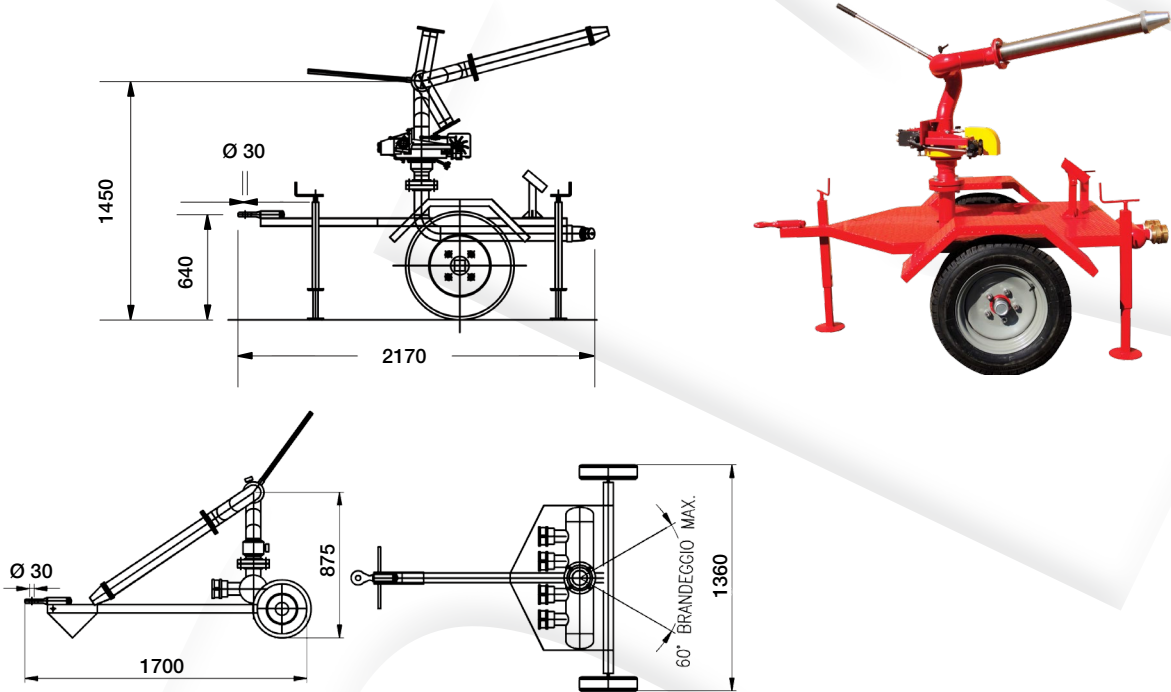

**Monitor trailer with on board foam tank (1000 liters)**

The above said trailers are shown in their general design, and detailed specification sheets are available from our offices upon request.

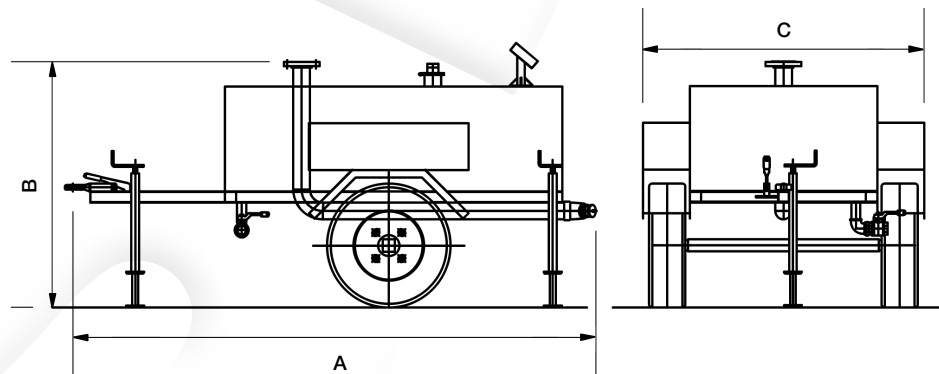

Code	Foam tank capacity litres	A mm	B mm	C mm	W* kg
TYK 020A A1KE	500	2500	1100	1500	600
TYK 040A A1LE	1000	2820	1310	1500	680

\* Weight value is meant for empty car